

Excurses and distances up river from Ten Oats.

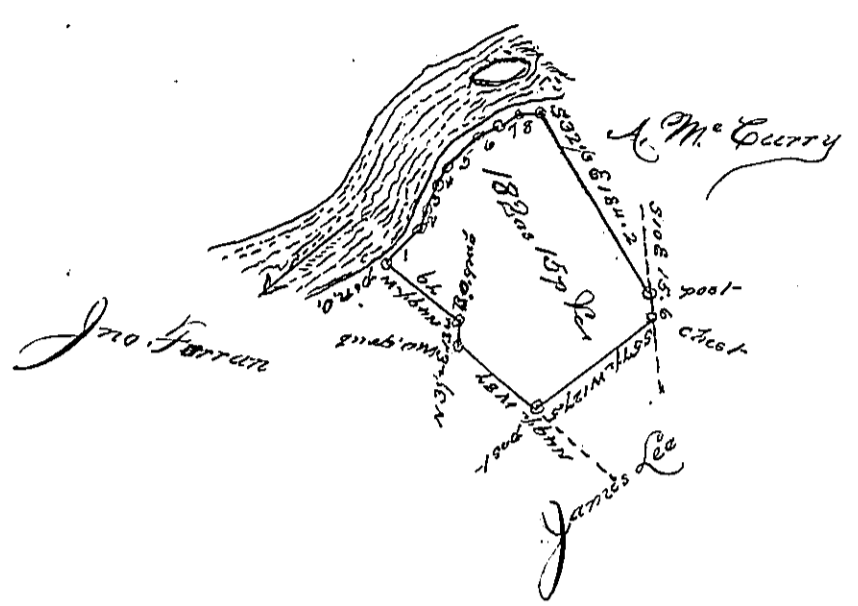

No. 1	N	40 1/2	E	35
" 2	N	25 1/2	E	15
" 3	N	11 1/2	E	23
" 4	N	28 1/2	E	15
" 5	N	47 1/2	E	44
" 6	N	56 1/2	E	12
" 7	N	63 1/2	E	27.5
" 8	N	71 1/2	E	19.50.

Draft of a tract of land situated in Crauberry Township Venango County East of and adjoining Allegheny river, a mile below the mouth of Oil Creek. Surveyed 9th November 1850 in pursuance of a Warrant granted to James Bannon dated 1st April 1850

Do
John Laporte Esq.
Surv. Genl.

Chas. H. Heydrick Esq.

IN TESTIMONY that the above is a copy of the original remaining on file in the Department of Internal Affairs of Pennsylvania, made conformably to an Act of Assembly approved the 16th day of February, 1833, I have hereunto set my Hand and caused the Seal of said Department to be affixed at Harrisburg, this

Ninth day of April 1891

Thos. J. Stewart
Secretary of Internal Affairs